



UNDERCOUNTER  
ICE MACHINE

# WU-0104-AC

## AIR COOLED

### KEY FEATURES:

- Stainless-steel exterior (durable & rust-resistant)
- Up to 105 lbs of ice production (70F/50F, 24H)
- Ice type: full cube
- 27 lbs of ice storage
- Control board diagnostics
- Improved freezing surface technology
- Easy access to the front air filter
- Stainless steel legs for height adjustment
- Air ventilation (front air in and out)
- Easy exchange front load **built-in** water filter
- R-600A refrigerant
- Power cord with NEMA 5-15 plug

### STANDARD WARRANTY:

- Ice Maker: 3-Year Parts & Labor
- Evaporator: 5-Year Parts & Labor
- Compressor: 5-Year Parts & 3-Year Labor



**FWU-0100R**

*Built in Carbon Block Water Filter  
(One unit is included when you buy a new machine)*



*Remove air filter by sliding forward*



*Front, in/out ventilation for optimal air flow and efficient production*



**Easy replacement  
Water Filter**

*A filter is required for this machine to operate. If your machine stops producing ice, it is likely time to replace this filter. It is recommended that you replace the filter every 6 months, or more often depending on the quality of your water.*

### CERTIFICATIONS



# WU-0100-AC

## UNDERCOUNTER ICE MACHINE

### PLAN VIEW

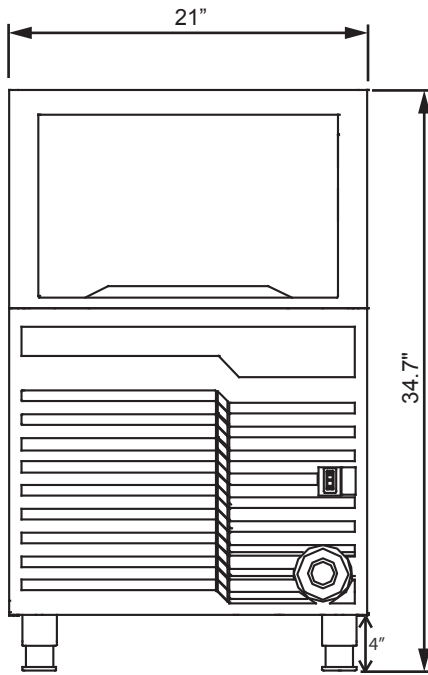

FRONT VIEW

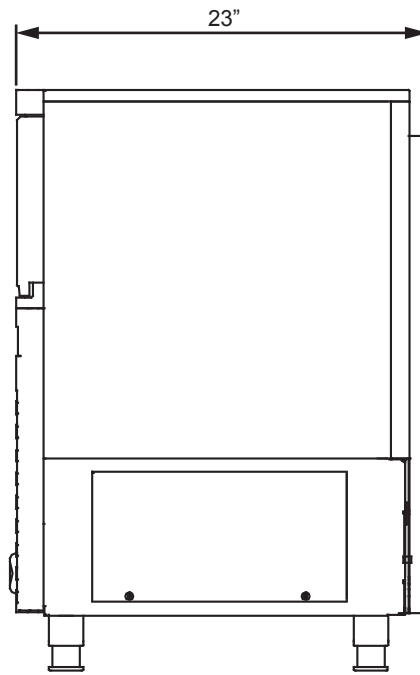

SIDE VIEW

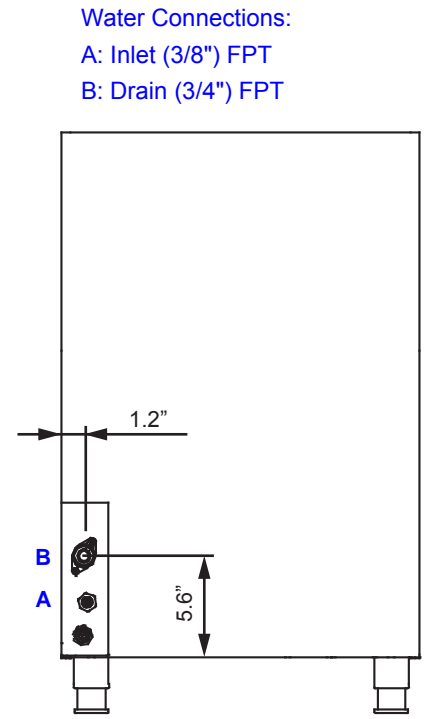

BACK VIEW

Water Connections:

A: Inlet (3/8") FPT

B: Drain (3/4") FPT

MODEL	DIMENSIONS	WIDTH	DEPTH	HEIGHT	WEIGHT
WU-0104-AC	Inch	21"	23"	34.7"	110 lbs (Net)

### SPECIFICATIONS

Model	Ice Shape	Ice Production per 24 hrs		Water usage Gal / 100 lbs ice	Power kWh / 100 lbs ice	Electrical (V/Hz/ph)	Condenser	Minimum Circuit Breaker (A)
		70 °F Air/ 50 °F Water	90 °F Air/ 70 °F Water					
WU-0104-AC	Cube	95 lbs	75 lbs	13.6	8.45	115 / 60 / 1	Air Cooled	15

OPERATING LIMITS	MIN	MAX
AMBIENT TEMP RANGE	50 °F	100 °F
WATER TEMP RANGE	50 °F	90 °F
WATER PRESSURE	14 psi (0.97 bar)	71 psi (4.89 bar)



### ICE SHAPE (CUBE)

7/8" X 7/8" X 7/8"



\* Design and specifications are subject to change without prior notice.