

STOCK POT RANGE

RAPID-BOIL AND PRECISION SIMMER



PERFORMANCE

The CookTek® Stock Pot Range is a freestanding stainless-steel design with a high-impact glass-ceramic cooktop, intended for back-of-house applications in commercial kitchens and restaurants.* An automatic shut-off feature, integral cooling fan, and self-diagnosing microprocessor allow for a safe kitchen environment. Precise control with 0–10 power settings provide efficient heating of any induction-compatible stock pot.**

FEATURES

- Available in 7,000 W (200–240 VAC) or 8,000 W (380-415 400 VAC), 3-phase models
- Freestanding design with stainless-steel housing
- High-quality internal electronics and heavy-gauge Litz wire
- Easy-to-clean high-temperature glass-ceramic cooktop
- Automatic pan detection allows for instant energy transmission to the stock pot
- Accommodates up to a 22" (559 mm) diameter stock pot**
- LED bar graph display
- Boils five gallons (19 liters) in 17 minutes
- Easy-to-use rotary knob with 0–10 power settings
- Automatic shut-off feature prohibits overheating
- Integral grease filter and air baffle maintain cooler, cleaner air intake
- Microprocessors continuously monitor vital components for overheating, power-supply issues, and other conditions
- Integral fan keeps internal components cool

STANDARD INCLUDED ACCESSORIES

- 6-ft (1.8 m) nominal plug and cord
- One-year field service warranty (U.S. and Canada)



*The Stock Pot Range is not approved for marine use.

**Induction cooking requires the use of induction-compatible (i.e., magnetic) cookware.

It is the owner and installer's responsibility to comply with all local codes. CookTek reserves the right to make substitutions of components or change specifications without prior notice.

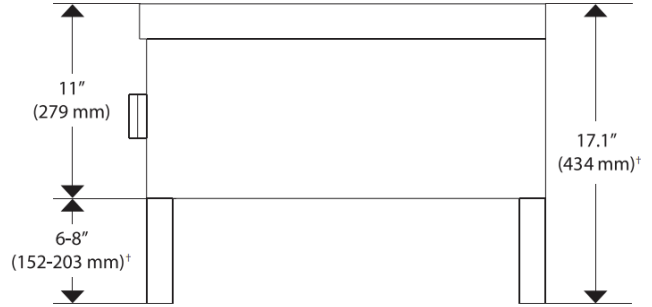
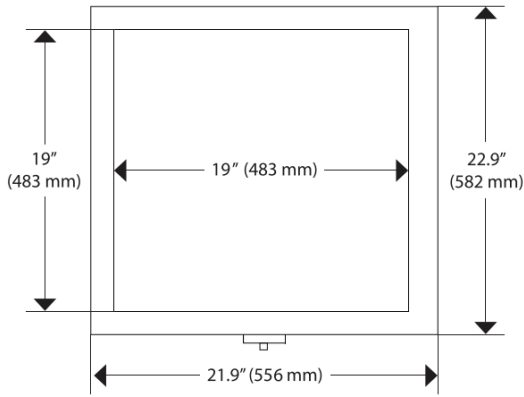

†Feet are adjustable. Height range is 6–8" (152–203 mm)

DIMENSIONS		
Height	17.1"	434 mm
Width	21.9"	556 mm
Depth	22.9"	582 mm
Weight	75.5 lb	34.2 kg
Cooking Surface Width	19"	483 mm
Cooking Surface Depth	19"	483 mm
Max Ambient Temperature	122 °F	50 °C
Internal Cooling Fan Displacement	140 CFM (3.9m ³ /min)	

ELECTRICAL SPECIFICATIONS MODEL: MSP7000-200		
UNITED STATES/CANADA		
646701	200–240 VAC, 50/60 Hz, 20 A, 100–7,000 W	NEMA L15-20P
UK/MIDDLE EAST		
646702	200–240 VAC, 50/60 Hz, 18-20.5 A, 3-Phase, 100–7,000 W	IEC 60309, 32 A, 3-pin
INTERNATIONAL		
646703	200–240 VAC, 50/60 Hz, 18-20.5 A, 3-Phase, 100–7,000 W	IEC 60309, 32 A, 3-pin

WALL CLEARANCE		
Front	2"	51 mm
Sides	2"	51 mm
Rear	2"	51 mm
Below	The space between unit legs should be kept free from obstruction.	

ELECTRICAL SPECIFICATIONS MODEL: MSP8000-400		
UK/MIDDLE EAST		
646202	380-415 V, 50/60 Hz, 10.5-11.5 A, 3-Phase, 6800-8000 W	IEC 60309, 16A, 5-pin
INTERNATIONAL		
646203	380-415 V, 50/60 Hz, 10.5-11.5 A, 3-Phase, 6800-8000 W	IEC 60309, 16A, 5-pin
ISRAEL		
646208	380-415 V, 50/60 Hz, 10.5-11.5 A, 3-Phase, 6800-8000 W	IEC 60309, 16A, 5-pin

SHIPPING INFORMATION		
Packaged Height	15.5"	394 mm
Packaged Width	25.5"	648 mm
Packaged Depth	28"	711 mm
Packaged Weight	116.6 lb	52.9 kg
Item Class	250 NMFC #26710	

⚠️ Dedicated circuit required for each installation.



NEMA L15-20P



IEC 309 – 3 Pin



IEC 309 – 5 Pin