

Refrigerated Mega Tops

- Mega Tops offer an all-in-one design solution for salad, sandwich and meal prep.
- Our trusted Mega Tops give staff the confidence of keeping ingredients fresh.
- Casters (2 locking) included for easy mobility.
- Features a full-length white polythene cutting board that provides a dedicated space to prep ingredients.



UCMT127-SS11A



UCMT132-SS11A



UCMT148-SS61A



UCMT160-SS61A

Model	Description	Voltage/Hz/Phase/Amps	Shipping Weight
UCMT127-SS11A	27" Refrigerated Mega Top (1 Door)	115v / 60hz / 1 / 3.4	242 lb
UCMT132-SS11A	32" Refrigerated Mega Top (1 Door)	115v / 60hz / 1 / 3.4	264 lb
UCMT148-SS61A	48" Refrigerated Mega Top (2 Doors)	115v / 60hz / 1 / 3.4	375 lb
UCMT160-SS61A	60" Refrigerated Mega Top (2 Doors)	115v / 60hz / 1 / 3.4	462 lb

Specifications

UCMT127-SS11A: 27 1/2" W X 35 1/2" D X 42 1/2" H

UCMT132-SS11A: 32 1/2" W X 35 1/2" D X 42 1/2" H

UCMT148-SS61A: 48" W X 35 1/2" D X 42 1/2" H

UCMT160-SS61A: 60 1/2" W X 35 1/2" D X 42 1/2" H

UCMT127-SS11A: 1 PVC coated wire shelf (included with purchase) holds (1) 12" x 20" pan and (3) 1/6 pans, pan rail holds (12) 1/6 pans

UCMT132-SS11A: 1 PVC coated wire shelf (included with purchase) holds (2) 12" x 20" pans, pan rail holds (12) 1/6 pans

UCMT148-SS61A: 2 PVC coated wire shelves (included with purchase) each hold (1) 12" x 20" pan and (3) 1/9 pans, pan rail holds (18) 1/6 pans

UCMT160-SS61A: 2 PVC coated wire shelves (included with purchase) each hold (1) 12" x 20" pan, (3) 1/6 pans and (3) 1/9 pans, pan rail holds (24) 1/6 pans

AISI 304 stainless steel interior and exterior

Autodefrost

CFC-free high-density polyurethane insulated cabinet

Electronic digital temperature control with alarms

Environmentally friendly R290 refrigerant

Factory pre-wired for dedicated outlet, 10 ft cord and plug included NEMA 5-15P

High efficiency compressor, side mount

High efficiency evaporator coil & condenser

NSF/ANSI Standard 7 compliant

Pan rail accommodates either 4" or 6" tall pans

Self-lubricating, sealed cast iron evaporator fan motor with high volume airflow design

Temperature range: 28°F to 46°F

Front (UCMT127-SS11A)

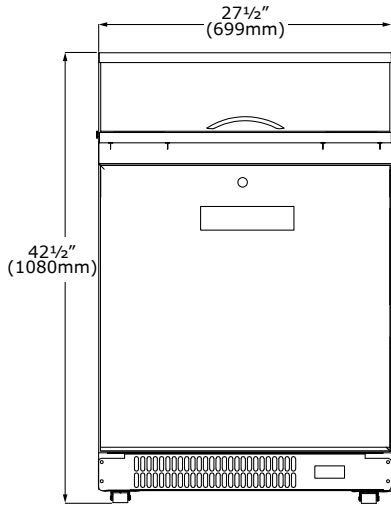

Front (UCMT132-SS11A)

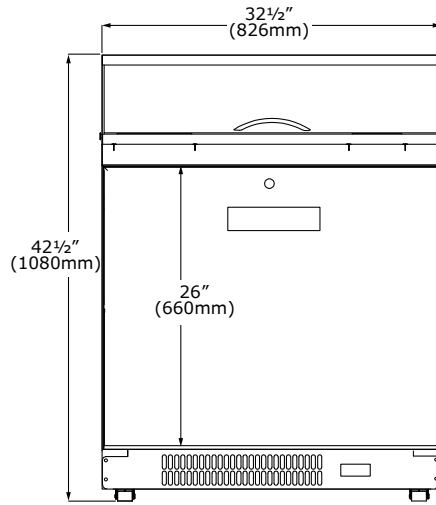

Side (All Models)

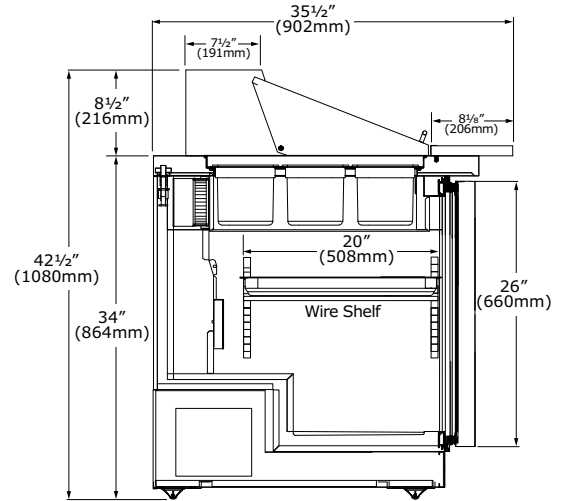

Top Rail (UCMT127-SS11A)

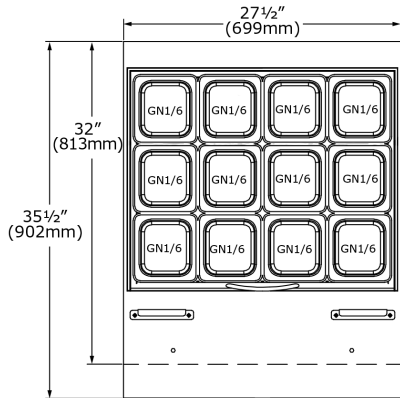

Top Rail (UCMT132-SS11A)

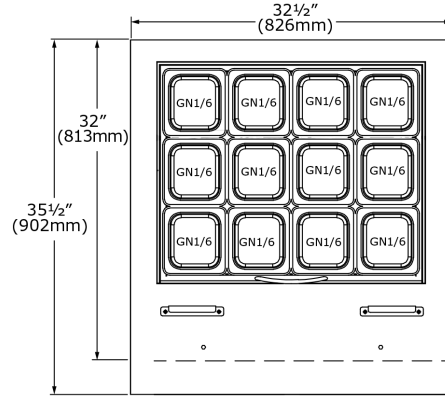

Door Interior (UCMT127-SS11A)

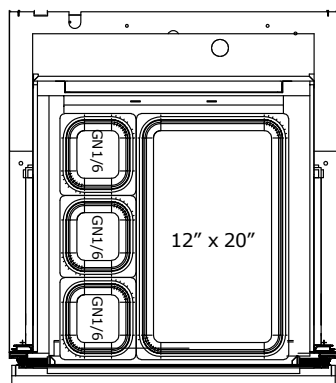

Door Interior (UCMT132-SS11A)

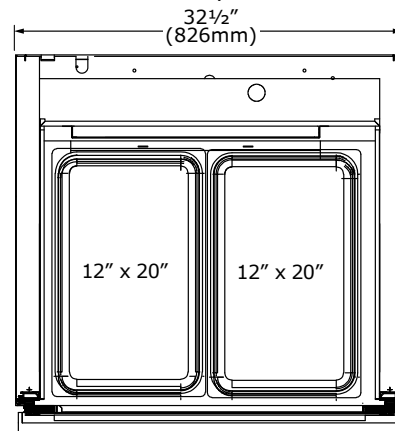

Front (UCMT148-SS61A)

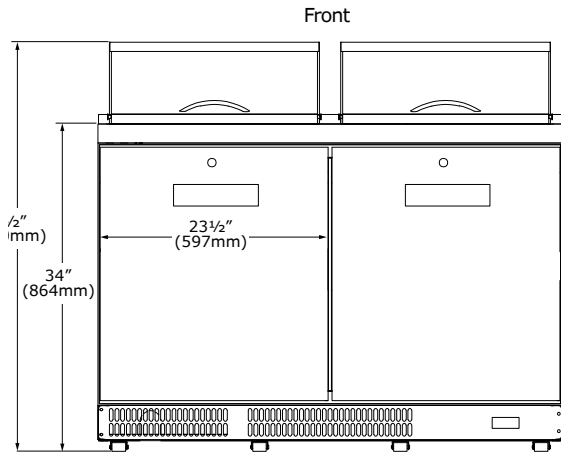

Front (UCMT160-SS61A)

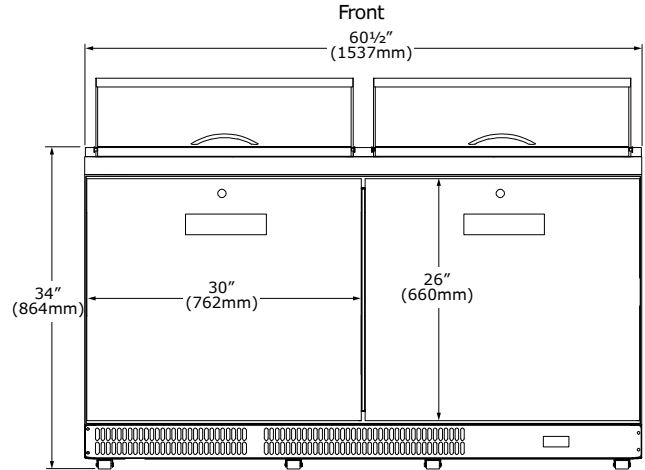

Top Rail (UCMT148-SS61A)

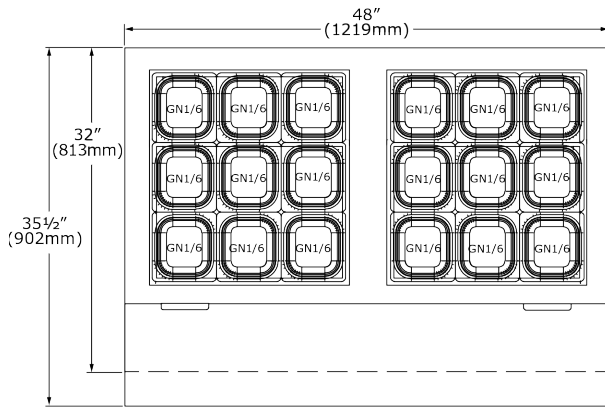

Top Rail (UCMT160-SS61A)

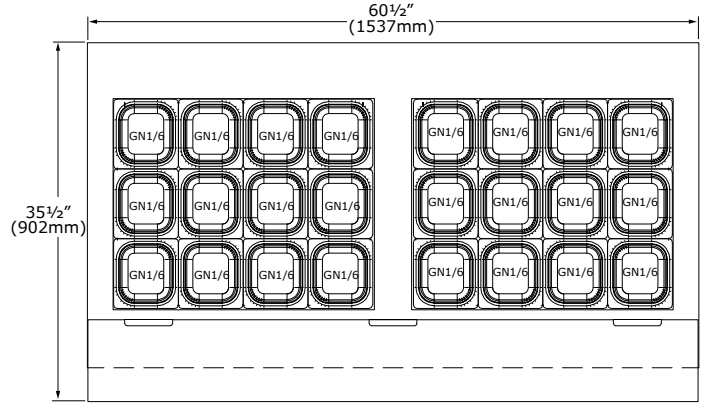

Door Interior (UCMT148-SS61A)

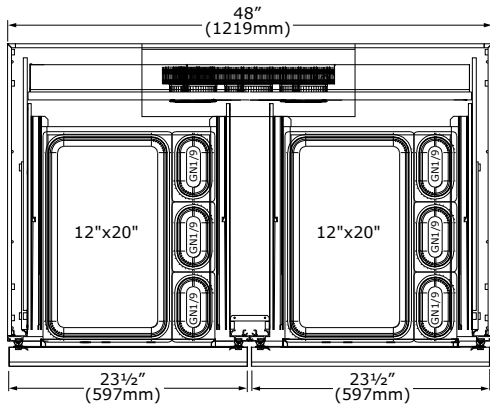

Door Interior (UCMT160-SS61A)

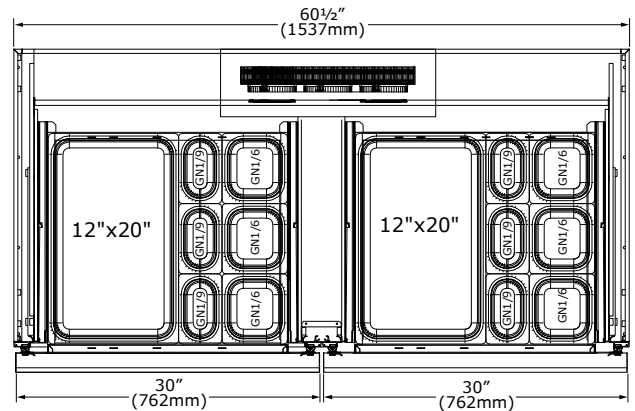

Commercial Warranty

3 Year (parts & labor) / 5 year sealed system (parts)
See complete warranty for details

