

49 cu ft Freezer, Reach-In

- Improve the flow and function of your space by having frozen items where you need them most
- Comfortably fits 18" x 26" sheet pans (not included)
- 4 casters included (2 locking) for easy mobility



UCFZ455-SS71A

Model	Description	Voltage/Hz/Phase/Amps	Shipping Weight
UCFZ455-SS71A	Freezer, Reach-In	115v / 60hz / 1 / 9.6	418 lb

Specifications

UCFZ455-SS71A dimensions: 80 23/32" H x 55 1/8" W x 31 1/2" D
AISI 441 stainless steel interior and exterior with locks
Autodefrost
CFC-free high-density polyurethane insulated cabinet
Electronic digital temperature control with alarms
Environmentally friendly R290 refrigerant: 4.2 oz (0.120kg)
Factory pre-wired for dedicated outlet, 11 ft cord and plug included NEMA 5-15P
High efficiency compressor, top mount
High efficiency evaporator coil & condenser
NSF/ANSI Standard 7 compliant
Self-lubricating, sealed cast iron evaporator fan motor with high volume airflow design
Temperature range: -13°F to 14°F
Volume of 49 cu ft
2 sections, includes 6 epoxy coated wire shelves

Accessories	Description	Shipping Weight
ULA4080584	(1) Stainless steel shelf guide for all reach-ins except UCRE553 & UCFZ553, 24 3/4"	.88 lb
ULAQ32-0002	(1) Epoxy coated wire shelf, 20 7/8" x 25 5/8" for reach-ins	7 lb
ULA89030400	Stainless steel adjustable leg kit includes 5 legs, 4-5/8" H to 7-1/8" H, M8 bolts	11.02 lb
ULA80110300	Interior LED lighting kit for solid door reach-ins	2.2 lb

Front (Open)

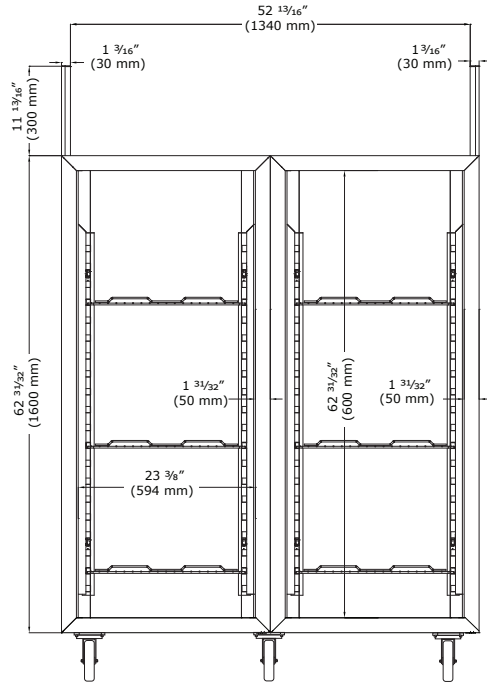

Front (Closed)

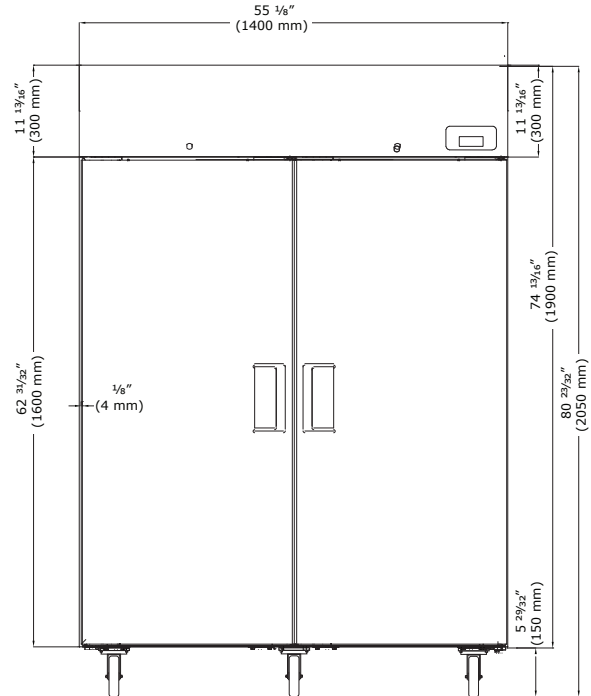

Top

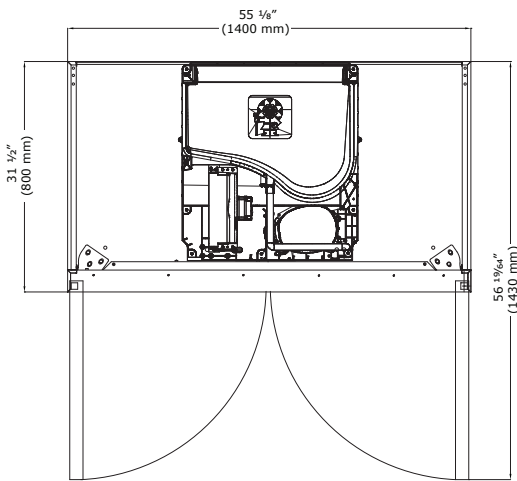

Side

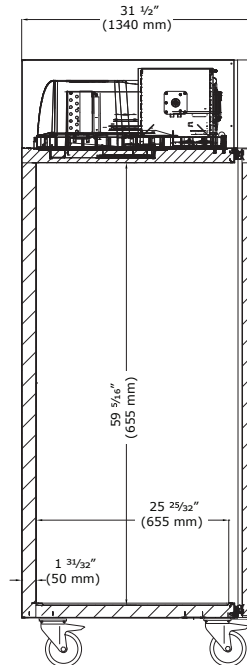

Commercial Warranty

3 Year (parts & labor) / 5 year sealed system (parts)
See complete warranty for details

