

Instruction Manual: 1900945  
Machine P/N: 1000990  
Rev 2

**POUR'D  
TOUCH**

## Contents

1. Font Box Contents.....	2
2. Counter Cut-Out.....	3
3. Installation.....	4
No Drip Tray.....	4
Drip Tray.....	5
Connecting Hoses with POUR'D Touch.....	6
POUR'D Touch Font with Boiler.....	6
POUR'D Touch Font with Chiller.....	7
POUR'D Touch Font with Boiler & Chiller.....	8
System Outputs.....	9
4. Priming.....	11
5. Calibration.....	12
6. Operator Settings.....	14
Set Recipes.....	14
Cleaning.....	15
7. Advanced Settings.....	16
Accessing Advanced Settings.....	16
General Settings.....	17
Graphics.....	17
Software Update.....	19
Service.....	20
Error Log.....	20
USB Connection.....	21
8. Operating Font.....	22
9. Cleaning & Maintenance.....	23
10. Troubleshooting.....	24

---

### Font Box Contents

1000990 – 1 EA	POUR'D Touch Font
1800623 – 0.5M	Drip tray hose
1800630 – 0.5M	Vent hose
2301250 – 1 EA	Hot tube to boiler
1400820 – 1 EA	8mm-1/4" reducer
1860551 – 1 EA	Drip tray
1860552 – 1 EA	Drip tray insert
1900945 – 1 EA	Instruction Manual POUR'D Touch Font

### Counter Cut Out

- The 100mm /4" cut out is only required for the font with drip tray.
- The font without drip tray requires the 32mm / 1 ¼" cut out only.
- Use a 32mm/ 1 ¼" & a 100mm /4" circular hole saw piece to make the holes.

Scale 1:1

$\phi 32\text{mm}$   
/ 1 1/4

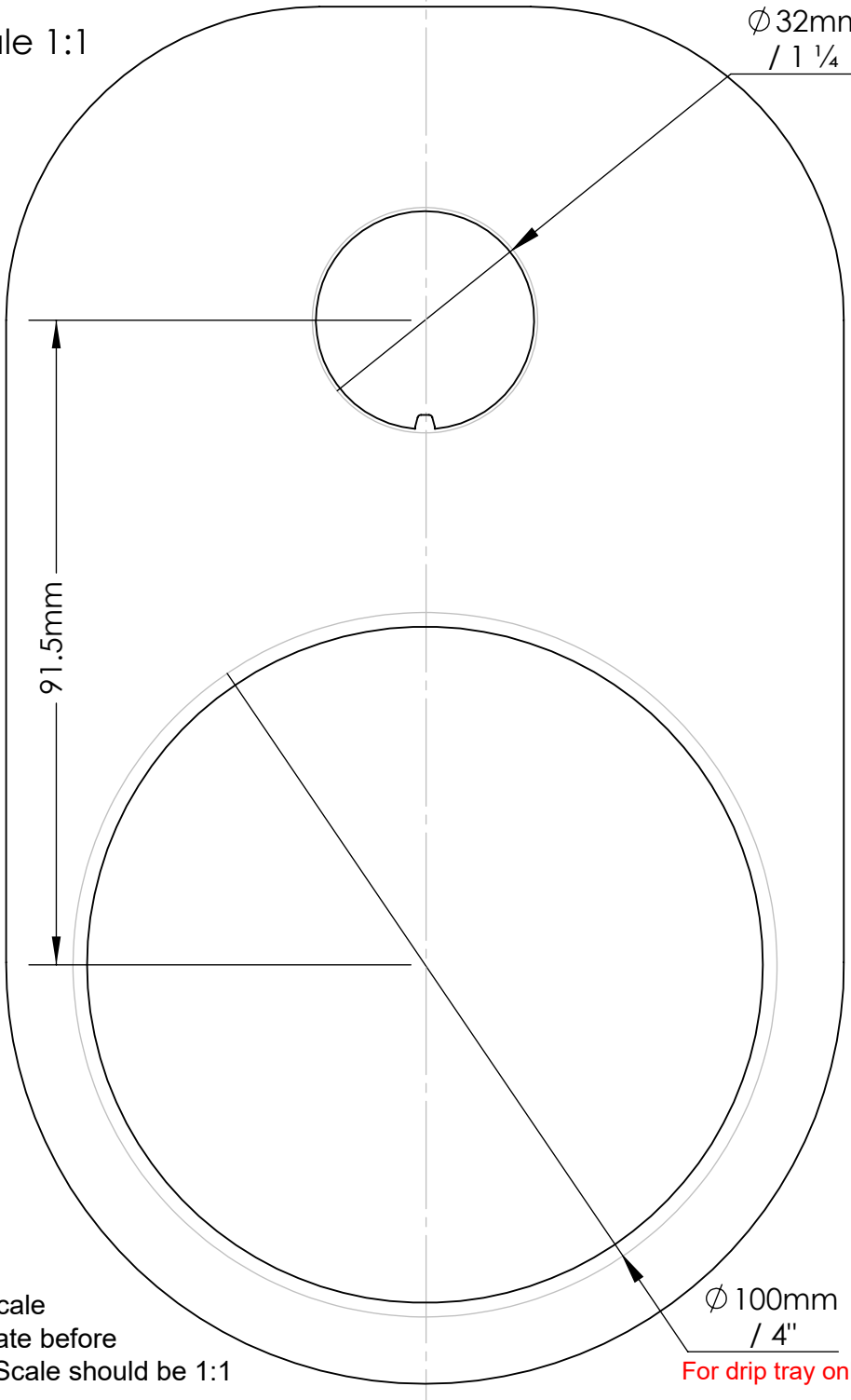

**NOTE:**  
Check scale  
of template before  
cutting. Scale should be 1:1

$\phi 100\text{mm}$   
/ 4"  
For drip tray only

# Installation

## 1. No Drip Tray

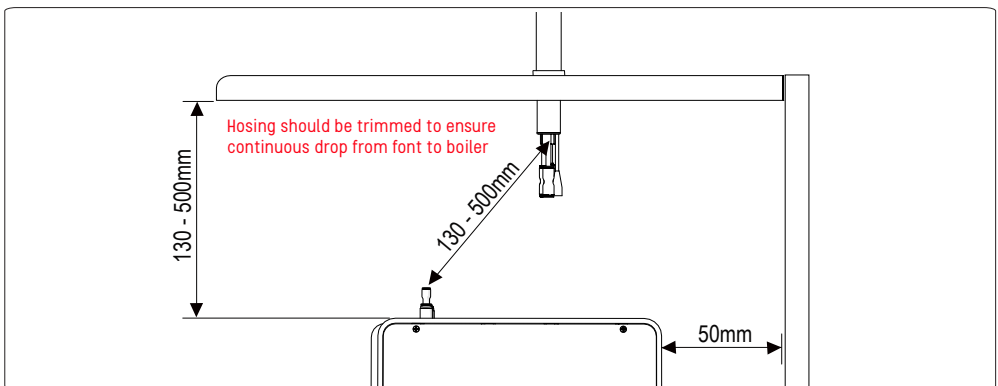
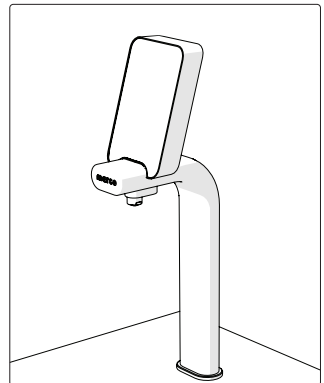
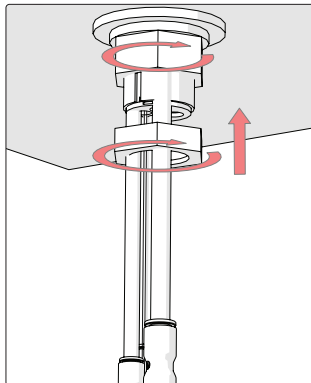
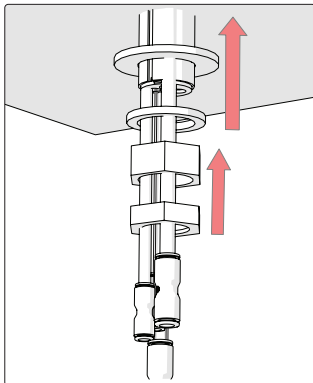
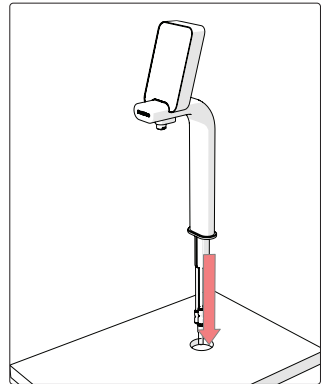
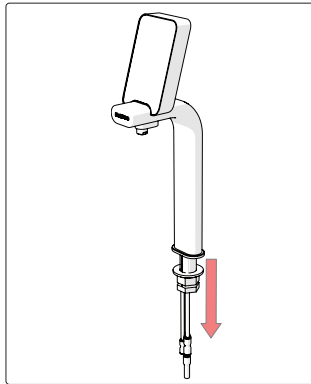
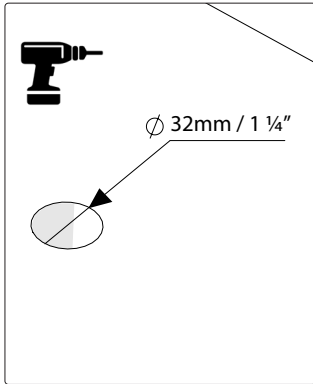

# Installation

## 2. Drip Tray

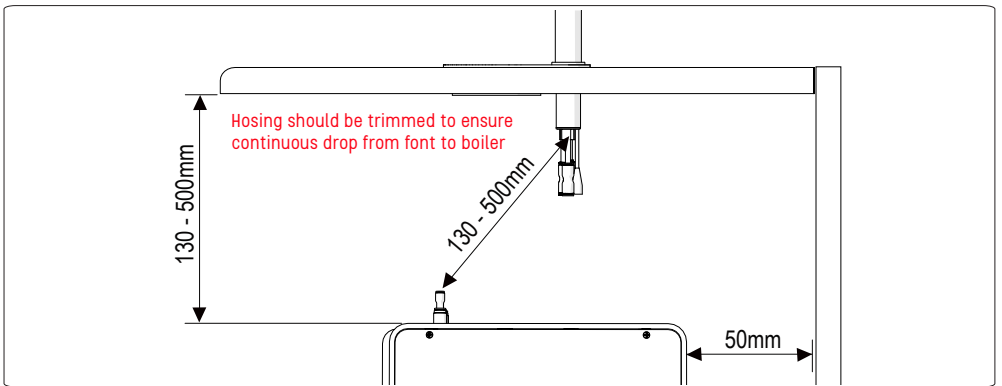
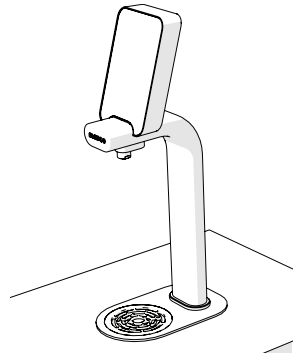
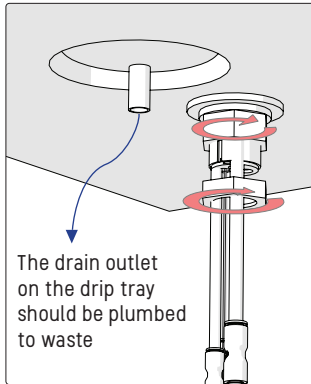
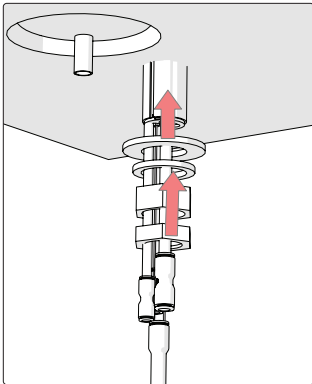
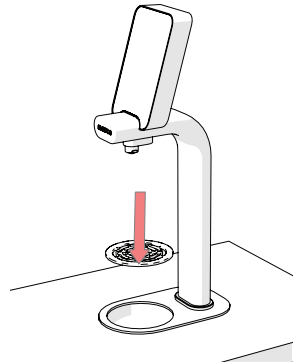
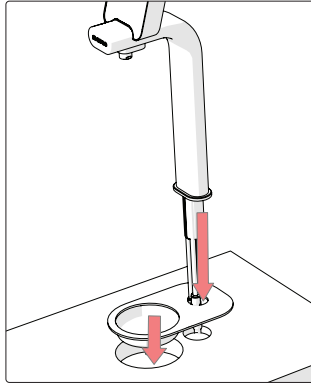
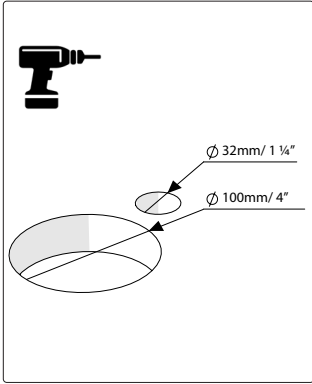

# Installation

## Connecting Hoses with POUR'D Touch Control Box

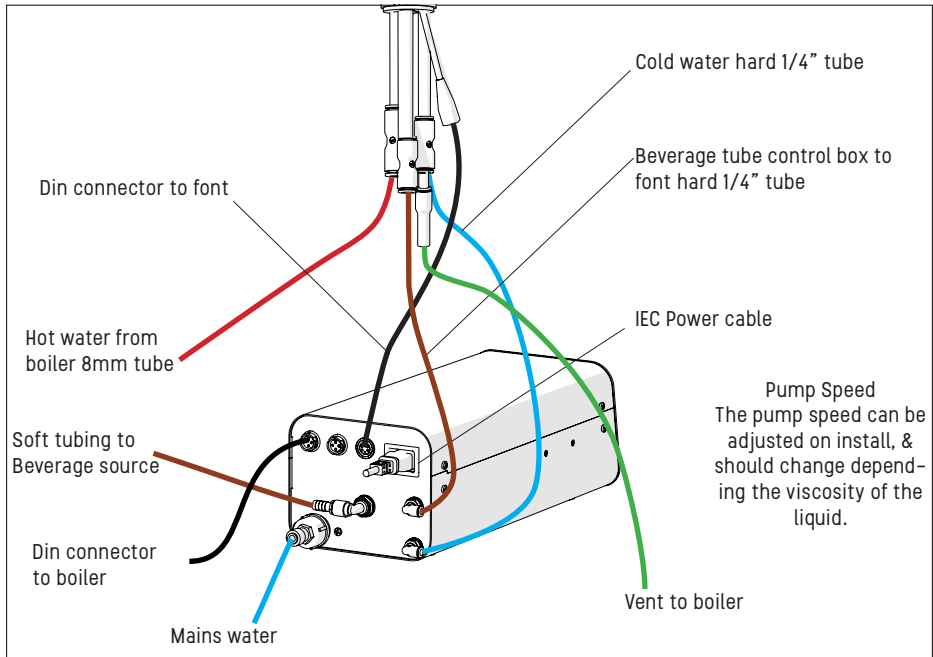

## POUR'D Touch Font with Boiler

Beverage Option - Diluted concentrate with hot or ambient water & concentrate shot

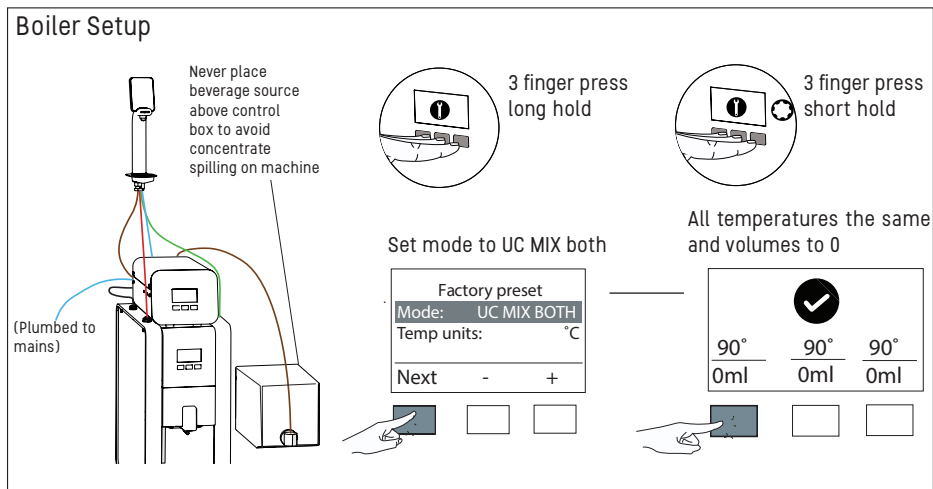

# Installation

## POUR'D Touch Font with Chiller

Beverage Option – Diluted concentrate with cold, sparkling or ambient water & concentrate shot

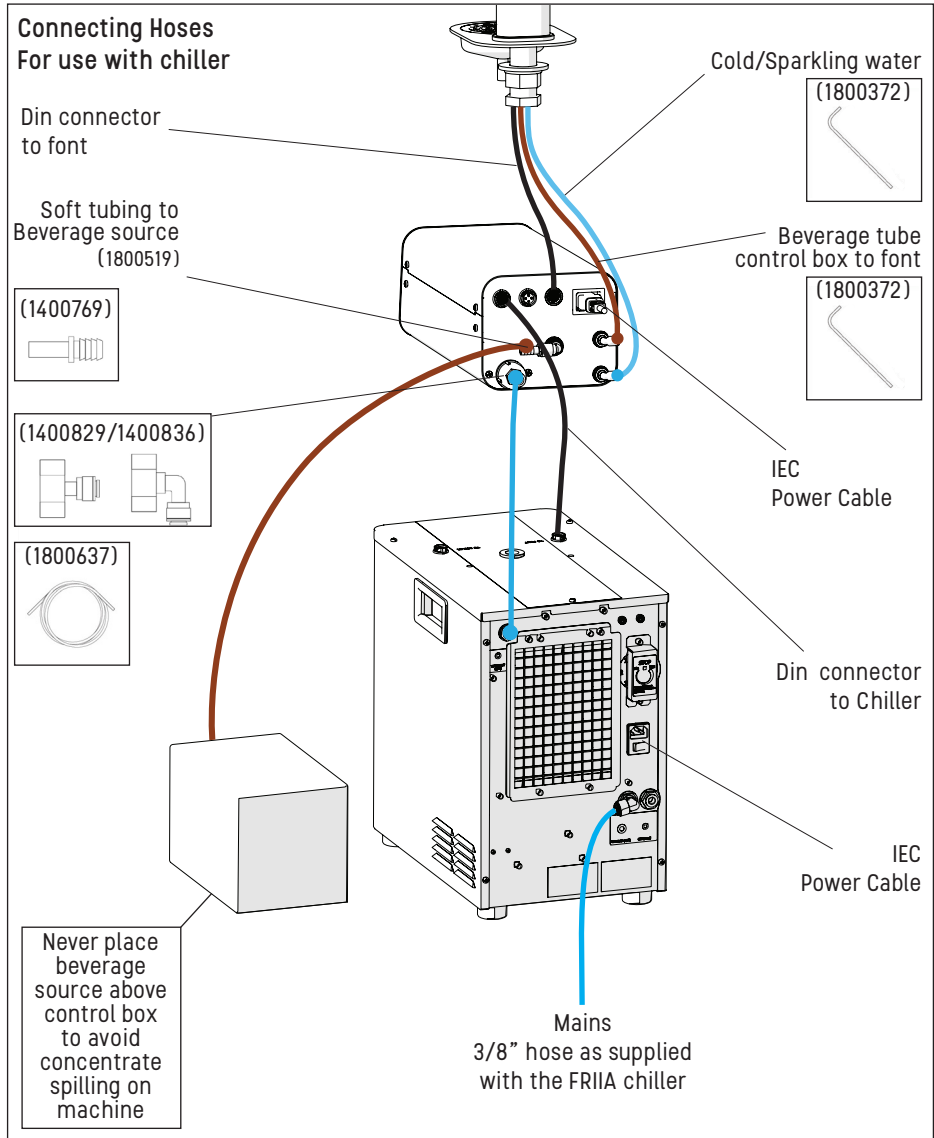

# Installation

## POUR'D Touch Font with Boiler and Chiller

Beverage Option – Diluted concentrate with hot, cold, sparkling or ambient water & concentrate shot

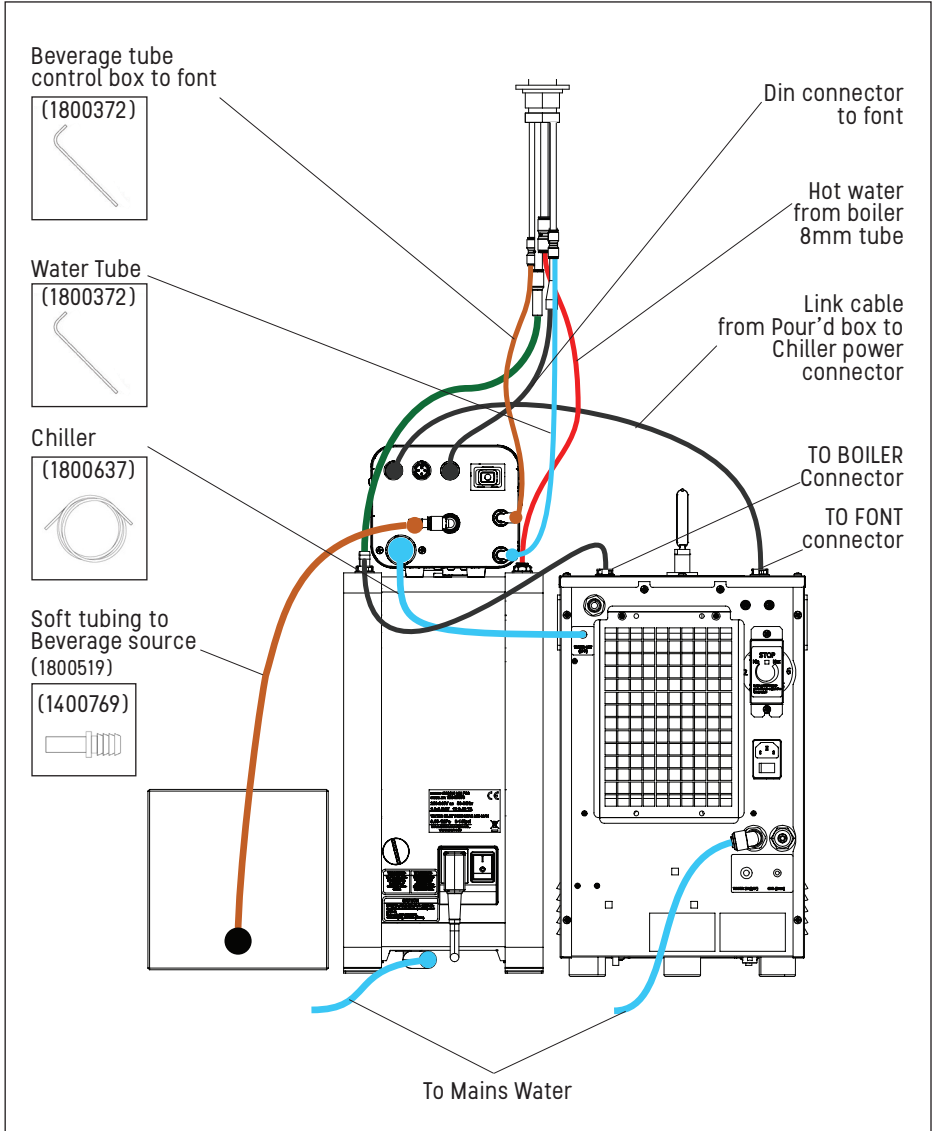

# Installation

## System Outputs

When the machine is turned on for the first time, the system outputs must be set.

1. **(Home Screen)**



2. Press and hold the bottom right corner of the screen for 5 seconds to access operator settings



3. **(Operator Settings Screen)**



4. Press settings icon to access advanced settings

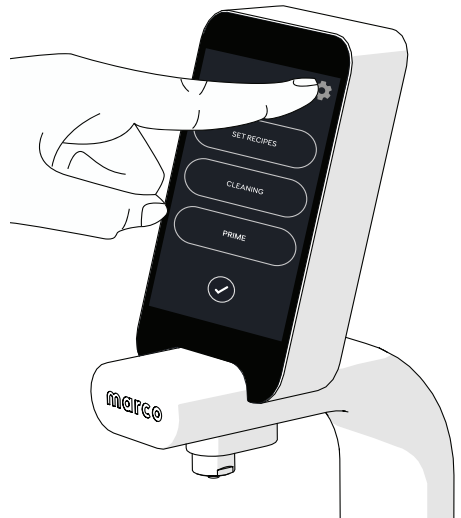

# Installation

5. Enter PIN  
Default PIN: 0000



6. (Advanced Settings Screen)



- 7.



8. Use the toggle switches to indicate the connected devices



## Priming

Ensure all lines are primed before starting the calibration process.  
Priming is in 'Operator Settings'. Before priming, place a vessel under the font.

1.



2.



To prime a line, press and hold a button until the desired liquid starts to dispense.

3.



4.

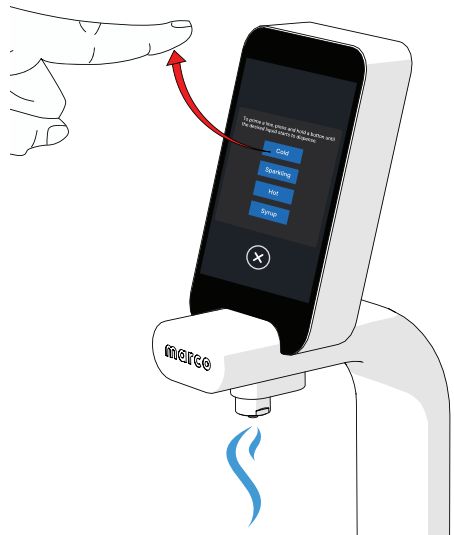

## Calibration

Before using the machine for the first time, the machine needs to be calibrated. Calibration is in 'Advanced Settings'.

1.



2.



3.



4.



## Calibration

5.



6.



7.



1. Perform a full calibration for syrup, cold, sparkling, and hot lines (if applicable).

2. Equipment needed: scales and vessel.

3. Follow the on-screen instructions for each step.

**NOTE:** 'Dispensed weight' refers to the weight of the liquid dispensed; therefore, the weight of the container used must be deducted.

# Operator Settings

## Set Recipes

1.



2.



3.



4.



# Operator Settings

Cleaning - MUST BE DONE DAILY

1.



2.



3.

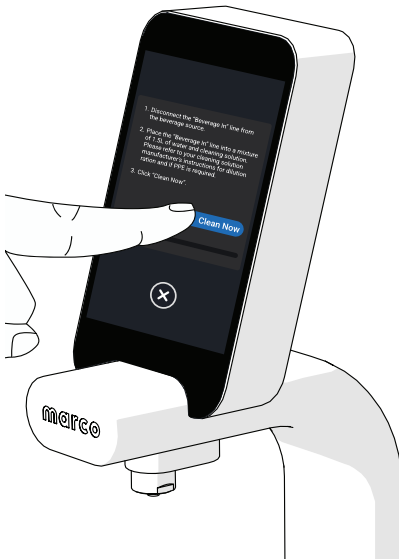

1. Disconnect the tubing from beverage source.

2. Put the tubing into a bucket of cleaning solution. We recommend using Urnex Cafiza 2 for coffee-based beverages or Urnex Rinza Milk System cleaner for alternative milk (follow Urnex instructions). Use a separate container to collect the wastewater.

4. Press "Clean Now" & follow the instructions on the screen.

5. Process will take 170 seconds and use 1.5L of water + Solution required per cycle.

6. Once the program is finished replace cleaning solution with clean ambient/cold water. (2L per cycle)

7. Press "Clean Now" on the screen.

8. Repeat until water comes out clear.

9. Reconnect the line to the beverage source.  
LEAVE THE LINE EMPTY OVERNIGHT

# Advanced Settings

## Accessing advanced settings

1.



2.

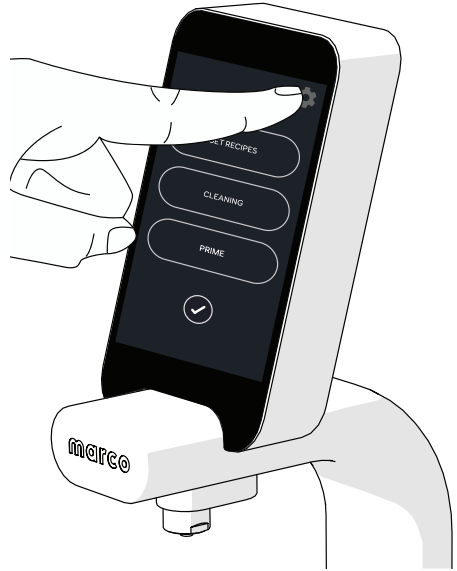

3.



4.



## Advanced Settings

General Settings – Change Language, PIN, Unit Settings, and Reset Factory Settings

1.



2.

Quick Dispense Mode Enables Push & Hold directly from the home screen.



Graphics – Upload / Change Backgrounds and Icons

Insert a USB drive formatted as 'FAT32', containing 480x854px images ended by 'bg.png'.

1.



2.



## Advanced Settings

3.



4.



5.



6.



## Advanced Settings

7.

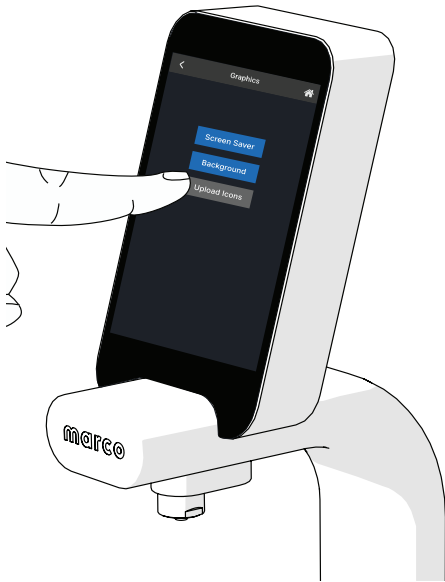

8.



## Software Update

Insert a valid USB drive formatted as 'FAT32' containing a valid .bin in the format "31xxyyy\_ver\_zzzz.bin" placed in the root directory (top level folder).

1.



2.



# Advanced Settings

## Service - Test Outputs

1.

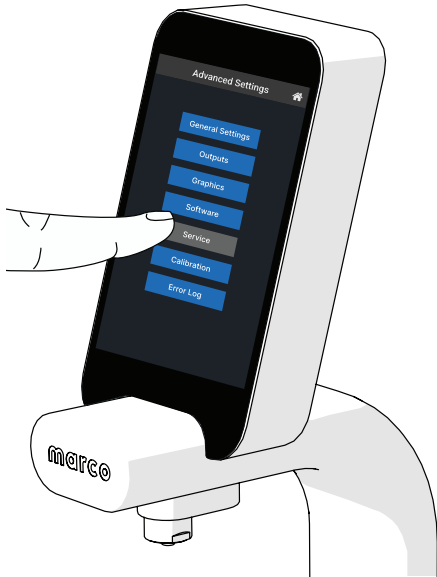

2.



## Error Log - Download / Erase Error Log

Records details of errors in the machine as a text file. Service personnel can download the text file to a USB stick to analyse.

1.



2.



## Advanced Settings

### USB Connection

USB connection is required for uploading graphics, downloading the error log, and updating the software.

1.

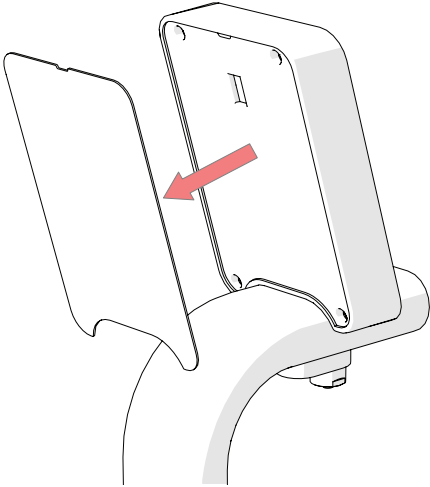

2.

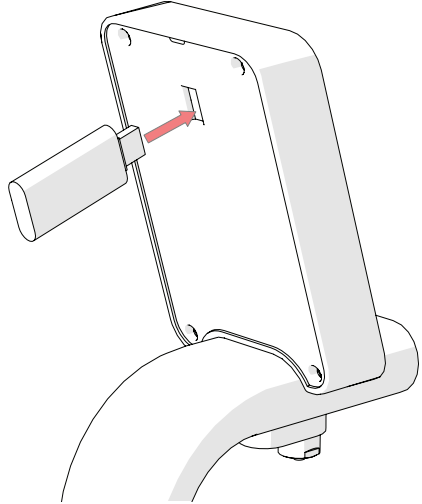

3.

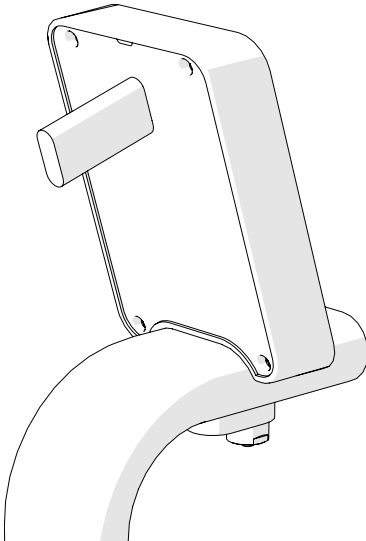

4.

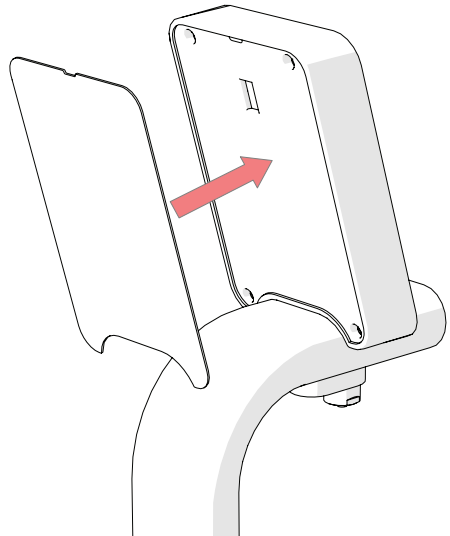

# Operating Font

## 1. Push & Hold

Beverage will dispense while the button is pressed and stop once released. Beverage volume not displayed under push & hold recipes.

1.



2.

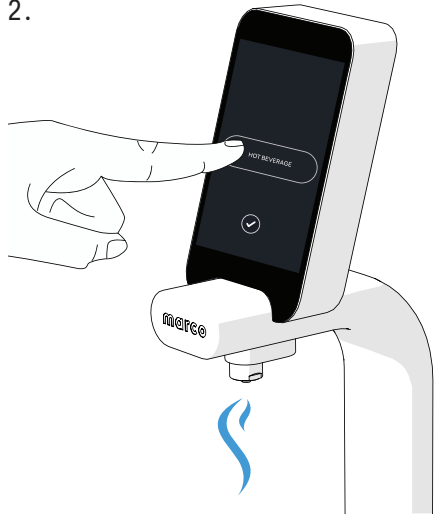

**Quick Dispense Mode (in General Settings)**  
Enables Push & Hold directly from the home screen.

## 2. Push & Release (Volumetric)

Dispenses a pre-defined volume of beverage (set in recipe).

Beverage volume displayed under push & release (volumetric) recipes.

3.

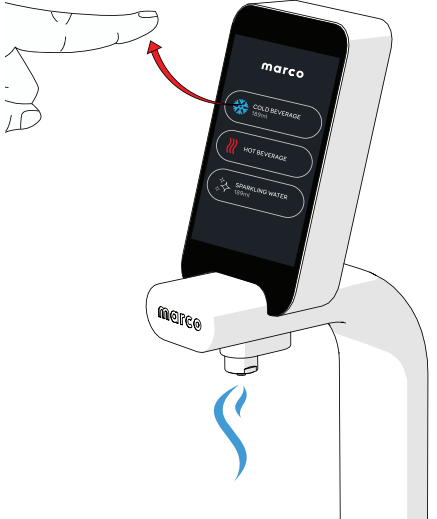
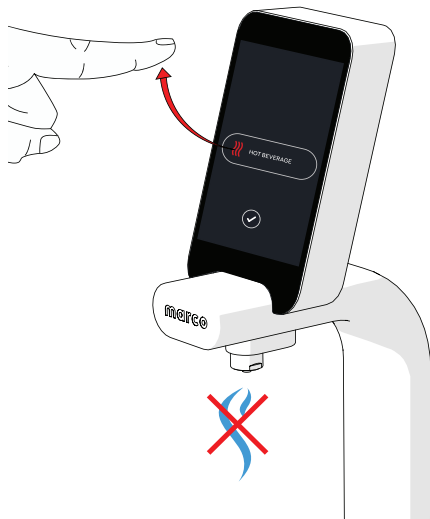

## Cleaning & Maintenance

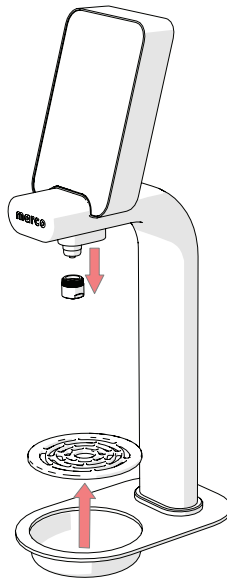

RISK OF SCALDING

Turn off the control box before cleaning to prevent accidental triggering of a dispense.

Beware of accidentally operating the font – especially when cleaning around the screen.

The appliance may not be immersed in water or cleaning solution. The exterior of this font may be cleaned with a damp cloth and a light detergent. The external surfaces of the appliance must not be cleaned by a water jet.

For cleaning the internal tubing and components, the recommended cleaning solution is Urnex Cafiza cleaner.

Twist off and wash out flow straightener.

Do not use abrasive cloths or creams, as this will spoil the finish of the font.

# Troubleshooting

The screen of the machine indicates various errors or problems with the machine. See diagnostic table below for further details.

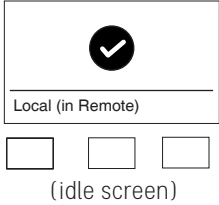
SCREEN DISPLAY	ACTION
No Water	Check mains water pressure, if pressure is okay then call service technician
Comms error	Check control box screen, should display the idle screen. If any other screen is displayed (settings screens), return to idle screen to fix error.  <p>(idle screen)</p>

Marco Beverage Systems Limited.  
63d Heather Road,  
Sandyford Industrial Estate,  
Dublin 18  
t: +353 (0)1 295 2674  
f: +353 (0)1 295 3715  
e: sales@marco.ie  
www.marco beveragesystems.com

